

FLUX OPEN PLAN

HOW TO ATTACH A WIRE TROUGH

Recommended Tools

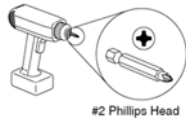

Hardware Required

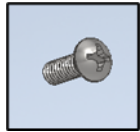

1/4-20 x 1/2" PHP
Machine Screws

Failure to comply with installation instructions will compromise the safety, durability and performance of this product, which may risk injury to the user of this product and/or diminish the product life cycle. Jasper Group assumes no liability in these instances.

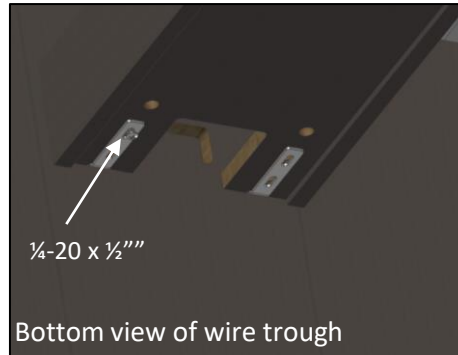

Figure 1

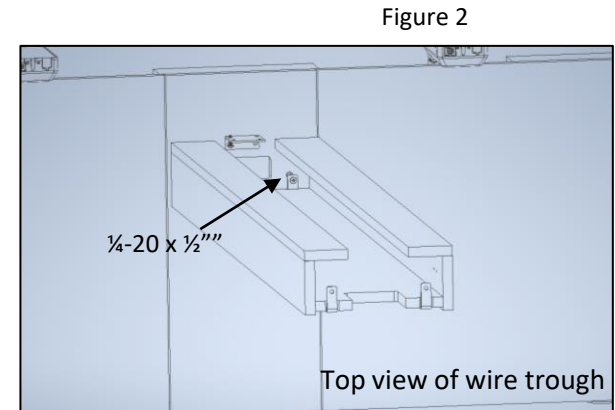

Figure 2

1. Attach the L-Brackets to the underside of the wire trough using 1/4-20 x 1/2" machine screws and the pre-drilled holes near the end of the trough (Figure 1)
2. Attach the L-bracket to the panel using the screws provided. Screws will go into the L-Brackets against the panel (Figure 2)
3. Repeat for other side